

DOCUMENT 00 91 13

ADDENDA

ADDENDUM NUMBER 1

DATE: March 10, 2023

PROJECT: St. Bartholomew Church Sanitary Lateral

PROJECT NUMBER: 22544A

OWNER: City of Newaygo

ENGINEER: Sidock Group. Inc.

TO: Prospective Bidders

This Addendum forms a part of the Contract Documents and modifies the Bidding Documents dated February 14, 2023, with amendments and additions noted below.

Acknowledge receipt of this Addendum in the space provided in the Bid Form. Failure to do so may disqualify the Bidder.

This Addendum consists of 7 pages and the following Documents:

No.	Drawing Title	Issue Date
C1	Sanitary Lateral Plan	3/10/23
C2	Sanitary Lateral Profiles	3/10/23

CLARIFICATIONS

1. Directional drill can be used for all sanitary sewer piping. Hand digging will still be required at two locations called out on sheet C1 to verify locations and depths of geothermal lines and underground electric. If directional drill is used instead of trenching, sanitary sewer piping shall be SDR 11 HDPE rather than SDR 26 PVC.
2. Directional drill logs shall be submitted to the engineer of record to verify depth and alignment of piping.
3. Contractor shall verify depth and location of the existing sanitary lateral at the proposed tie in location to proposed sanitary sewer. If depth and/or location are different from what is shown on sheets C1 and C2, the contractor shall inform the engineer of record in order to obtain updated inverts at proposed manholes.
4. The connection between the existing lateral and HDPE SDR 11 shall be a Romac XR501 coupling. Depending on whether there are differing slopes between the new and existing lines, elbows may be necessary to ensure pipes on either end of the connection enter at the same slope.

CHANGES TO CONTRACT DOCUMENTS

1. Section 01 01 00 Summary of Work was updated to include additional point of existing lateral depth and location verification by contractor and to change the reference of manhole 2 to manhole 3.

DRAWING REVISIONS OR ADDITIONS TO CONTRACT

1. Sheet C1 – A note was added for the contractor to expose and verify depth and location of the existing lateral at the proposed tie in point at the right of way. PVC was added to the SDR 26 pipe description.
2. Sheet C2 – The legend was updated to include only one callout for proposed sanitary sewer.

END OF DOCUMENT



City of Newaygo St. Bartholomew Church Sanitary Lateral

**Pre-Bid Meeting Minutes
March 7, 2023 11:00 a.m.**

Date: March 7, 2023 Time: 11:00 a.m.

Location: Newaygo City Hall

Attendee List: Attached

Meeting Notes

I. Introductions/Sign-in

II. General

A. Project Summary:

B. Owner: City of Newaygo

C. Architect/Engineer: Sidock Group, Inc.
379 W. Western Ave.
Muskegon, MI 49440
Katelyn Gress, P.E., Project Manager
Phone: (231)722-4900 x 225
E-mail: kgress@sidockgroup.com

III. Schedule

- Last Date for Bidder's RFI's: Noon March 10, 2023.
- Bid Due Date: March 17, 2023, 2:00 p.m. local time.
- Bids will be opened publicly after time for receipt of Bids and read to all present.
- Begin Construction: March 29, 2023
- Contract Time: Substantial Completion June 9, 2023 and Final Completion June 16, 2023.

IV. Engineer Comments

- Summary of Work Revision – Change reference of Manhole 2 to Manhole 3.
- The pre-bid meeting minutes will be issued as an addendum. Any addendum will be issued electronically, including drawings. You will be asked to verify electronic receipt of the addendum.
- “Or equal” means Engineer approved equal.

- “Or equal” means Engineer approved equal. A side-by-side comparison and all required product information that will allow a quick verification of an equal must be submitted. If anything is missing or confusing, the substitution will be denied. Engineer will not be calling for clarifications. Last day for RFI’s is the last day for Engineer approved equal requests.

V. Open Questions

- Question: Can directional drill be used for all sanitary piping?

Answer: To be answered in Addendum 1. Upon further inspection, yes, directional drill can be used for all sanitary piping. Hand digging will still be required at two locations called out on sheet C1 to verify locations and depths of geothermal lines and underground electric. If directional drill is used instead of trenching, sanitary sewer piping shall be SDR 11 HDPE rather than SDR 26 PVC.

- Question: What type of connection can be used between the HDPE SDR 11 and existing sanitary lateral?

Answer: To be answered in Addendum 1. Upon further inspection, a Romac XR501 coupling shall be used to connect the HDPE SDR 11 pipe to the existing sanitary lateral. Depending on whether there are differing slopes between the new and existing lines, elbows may be necessary to ensure pipes on either end enter the connection at the same slope.

- Question: What method should be used to ascertain the slope of directional drilled piping?

Answer: To be answered in Addendum 1. Per consultation with engineer of record, directional drill logs shall be submitted to the engineer of record to verify depth and alignment of piping.

Information included in these Meeting Minutes and attached to this document shall become part of the Contract Documents.

Email comments or corrections to Katelyn Gress at kgress@sidockgroup.com.

City of Newaygo
 St. Bartholomew Church Sanitary Lateral
 Pre-Bid Meeting Attendee List
 March 7, 2023

Company Name & Contact	Address	Phone / Fax	Email
City of Newaygo Jon Schneider	28 N. State Road, Newaygo, MI 49337	231-652-1657 / 231-652-1650	jons@newaygocity.org
City of Newaygo Ron Wright	28 N. State Road, Newaygo, MI 49337	231-652-1657 / 231-652-1650	twight@newaygocity.org
Sidcock Group, Inc. Katelyn Gress, P.E.	379 W. Western Avenue Muskegon, MI 49440	231-722-4900 / 231-722-4955	kgress@sidcockgroup.com
Oak Ridge Excavating Gary Hopper	2859 W 32 nd Street PO Box 248 Grant	231-934-6287 231-629-0501	gary@oakridgeexcavating.com ghopper@oakridgeexcavating.com
Dan's Excavating Service, Inc ^{Spencer}	7435 Miller Estates Caledonia, MI 49316	(616) 443-4156	office@SPSP.com
SPS Pro Plumbing			
Ryerson Brothers	2979 Industrial Pkwy Muskegon, MI 49445	231-888-4020	marvin@ryersonbros.com
Gerber Const.	20270 W. US-10 Reed City, MI 49677	(231)-629-1390	Justin@GerberConstructionCo.com

SECTION 01 01 00

SUMMARY OF WORK

PART 1 - GENERAL

1.01 SUMMARY OF WORK

Work shall include construction of approximately 500 feet of 6-inch sanitary lateral. Approximately 192 feet shall be a directional drill beneath the parking lot. There will be three new manholes constructed including one over the existing lateral coming out of the church. The lateral out of the church shall be plugged after the new manhole is constructed. Service to the church shall be maintained until the new 6-inch lateral is ready for use. Tie the new lateral in at Brooks road to an existing riser. At the beginning of construction, the contractor shall expose and obtain the invert elevation of the existing lateral out of the church at manhole 3 and expose and obtain the invert elevation and location of the existing lateral at the proposed tie in point at the right of way. The elevations and locations, if different than shown, shall be submitted to the engineer. The grade elevations of the lateral exiting the church and the lateral off the main will then be adjusted up or down by the difference. Test line according to the specifications. Backfill excavations per trench details.

The pipe material for the project shall be 6-inch SDR 26 pipe for all piping except the directional drill. The piping for the directional drill shall be either 6-inch HDPE SDR 11 or 6-inch Certa-Lok C900/RJIB.

One tree and one stump shall be removed as shown on the drawings. Backfill with existing soil or sand and top with 4-inches of topsoil and seed. Dispose of tree and stump offsite.

Note the geothermal lines and electrical shown on the drawings. Exact location unknown but hand excavation in these areas will be required.

All areas shall receive 4-inches of topsoil and seed and graded back to meet existing grades.

END OF SECTION

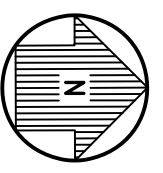

PROPOSED 6" SANITARY LATERAL
SCALE: 1" = 40'

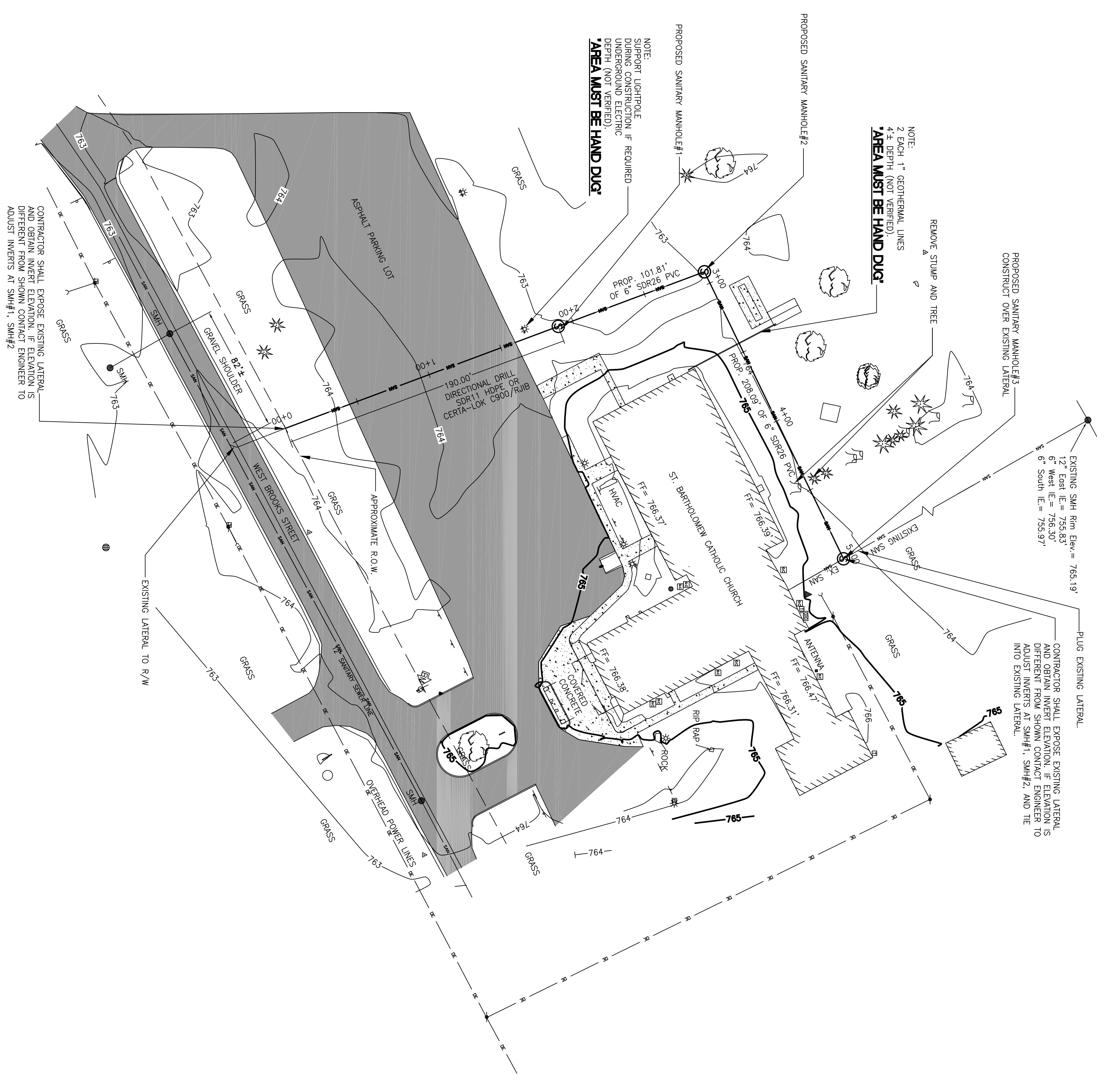

NOTE:
SUPPORT LIGHTPOLE
DURING CONSTRUCTION IF REQUIRED
UNDERGROUND ELECTRIC
DEPTH (NOT VERIFIED).
AREA MUST BE HAND DUG.

NOTE:
2 EACH 1" GEOTHERMAL LINES
4 ± DEPTH (NOT VERIFIED).
AREA MUST BE HAND DUG.

REMOVE STUMP AND TREE
CONSTRUCT OVER EXISTING LATERAL

EXISTING SMH Rim Elev. = 765.19'
12" East IE. = 755.53'
6" West IE. = 755.30'
6" South IE. = 755.97'

CONTRACTOR SHALL EXPOSE EXISTING LATERAL
AND OBTAIN INVERT ELEVATION. IF ELEVATION IS
DIFFERENT FROM SHOWN CONTACT ENGINEER TO
ADJUST INVERTS AT SMH#1, SMH#2, AND THE
INTO EXISTING LATERAL.

CONTRACTOR SHALL EXPOSE EXISTING LATERAL
AND OBTAIN INVERT ELEVATION. IF ELEVATION IS
DIFFERENT FROM SHOWN CONTACT ENGINEER TO
ADJUST INVERTS AT SMH#1, SMH#2

LEGEND

- ▲ - TRAVERSE POINT
- - WELL
- - HIGHWAY
- - MONUMENT
- - FOUND IRON STAKE
- - SET IRON STAKE
- - SIGN
- - RR SIGN
- - GUY ANCHOR
- - UTILITY POLE
- - LIGHT POLE
- - POST
- - SOIL BORING
- - U.G. UTILITY MARKER
- - MAILBOX
- - SHRUB
- - DECIDUOUS TREE
- - CONIFEROUS TREE
- - EXISTING FIRE HYDRANT
- - EXISTING WATER VALVE
- - EXISTING GAS METER
- - EXISTING WATER METER
- - EXISTING TELEPHONE RISER
- - EXISTING ELECTRIC METER
- - EXISTING CATCH BASIN
- - EXISTING ROUND CATCH BASIN
- - EXISTING UTILITY MANHOLE
- - EXISTING STORM MANHOLE
- - EXISTING SANITARY MANHOLE
- - EXISTING TELEPHONE MANHOLE
- - EXISTING OVERHEAD UTILITY LINE
- - EXISTING WATER UTILITY LINE
- - RIGHT-OF-WAY
- - EXISTING ELECTRIC UTILITY LINE
- - EXISTING GAS UTILITY LINE
- - EXISTING STORM UTILITY LINE
- - EXISTING SANITARY UTILITY LINE
- - EXISTING WATER UTILITY LINE
- - EXISTING TELEPHONE UTILITY LINE
- - PROPOSED SANITARY SEWER
- - PROPOSED SANITARY MANHOLE

ALL UTILITIES AS SHOWN ARE APPROXIMATE LOCATIONS DERIVED FROM
ACTUAL MEASUREMENTS AND AVAILABLE RECORDS. THEY SHOULD NOT BE
THEY ARE THE ONLY UTILITIES IN THE AREA.

ST. BARTHOLOMEW CHURCH
CITY OF NEWAYGO, MICHIGAN
SANITARY LATERAL PLAN
1000 W. BROOKS STREET

Drawn	ELS			
Checked	WPF			
Scale	1"=40'			
Date	9-26-22			
Rev. By				
Rev. Date				
	B	ADDENDUM 1	3/10/23	KHG
	A	ISSUE FOR BID	2/21/23	WPF
	Rev.	Description	Date	By

Sidock Group, Inc.
ENGINEERS • ARCHITECTS • CONSULTANTS • PROJECT MANAGERS
43155 MAIN STREET, SUITE 2310 • NOVI, MICHIGAN 48375 • (248) 349-4500
379 W. WESTERN AVE., SUITE 200 • MUSKEGON, MICHIGAN 49440 • (231) 722-4900

ASSIGNED FOR REVIEW
DATE: 2/22/23
BY: WPF
OWNER APPROVAL
DATE: 2/22/23
BY: [Signature]
JOB: 222544.A
FILE NAME: 222544.A
STREET: C1

BENCHMARK INFORMATION
NORTHWEST BOLT ON TOP FLANGE FIRE HYDRANT
AT MAIN ENTRANCE TO CHURCH.
ELEVATION= 769.97'

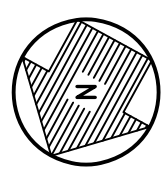

PROPOSED SANITARY SEWER PROFILE

SCALE: 1" = 40'

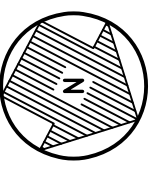
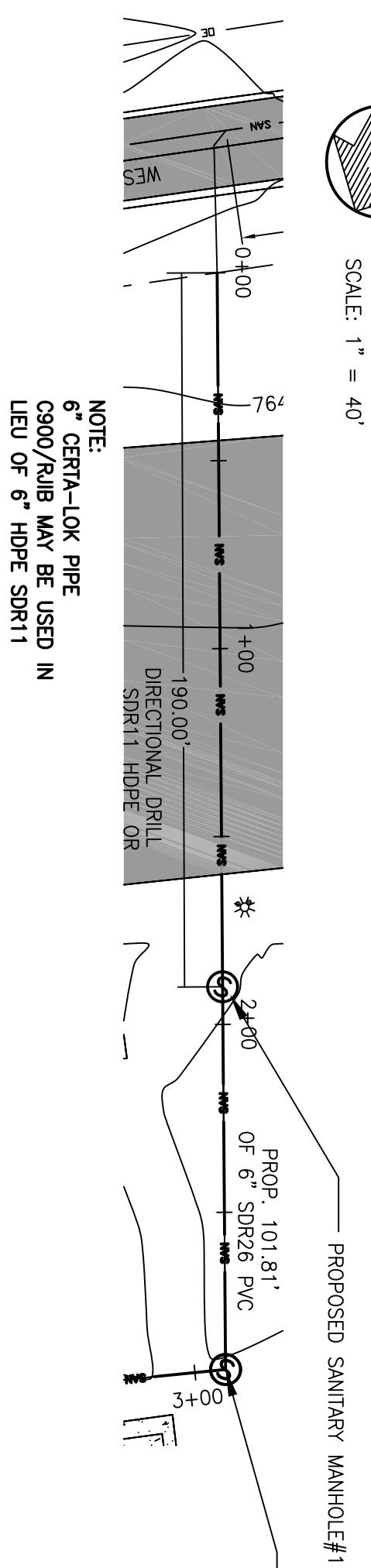

PROPOSED SANITARY SEWER PROFILE

SCALE: 1" = 40'

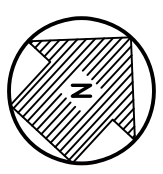
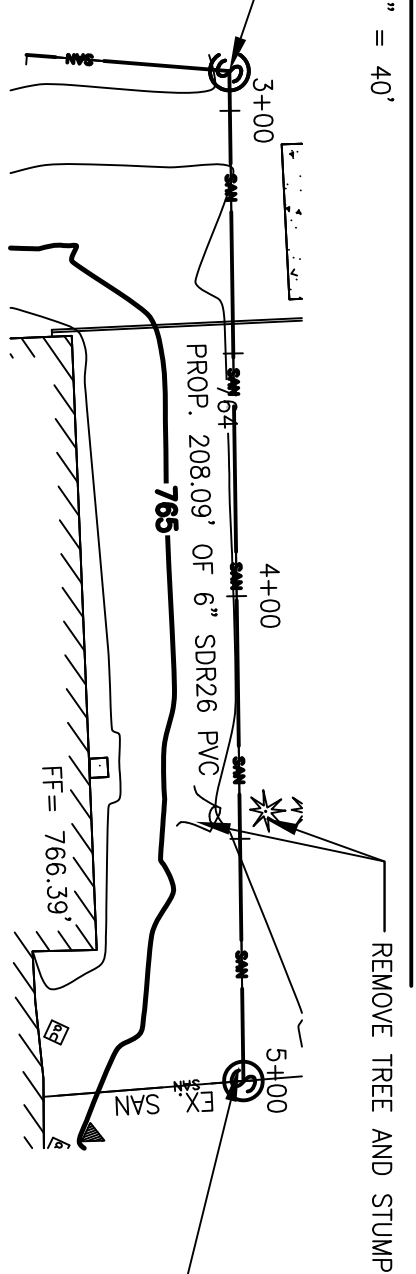

PROPOSED SANITARY EXTENSION PROFILE

SCALE: 1" = 40'

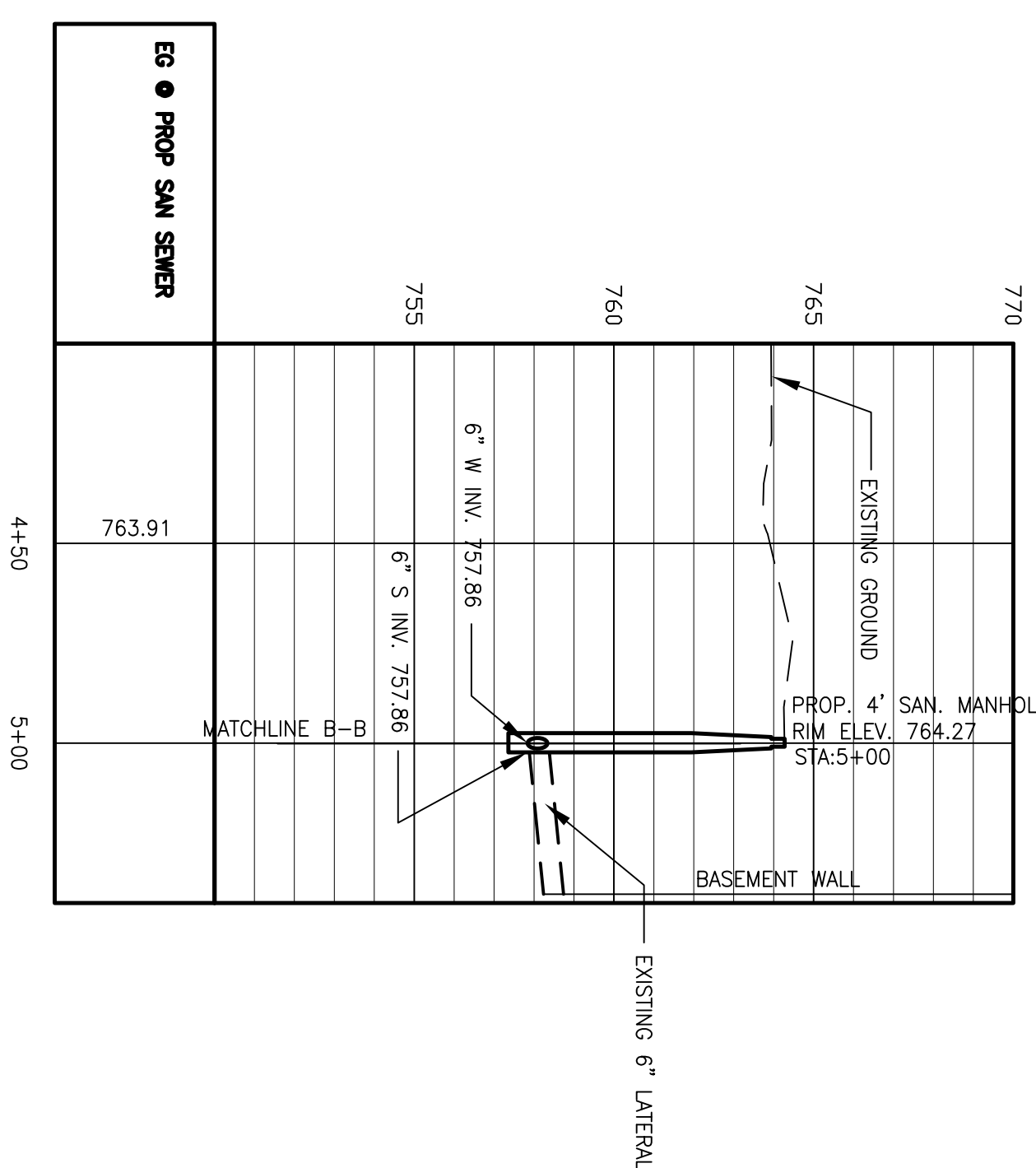
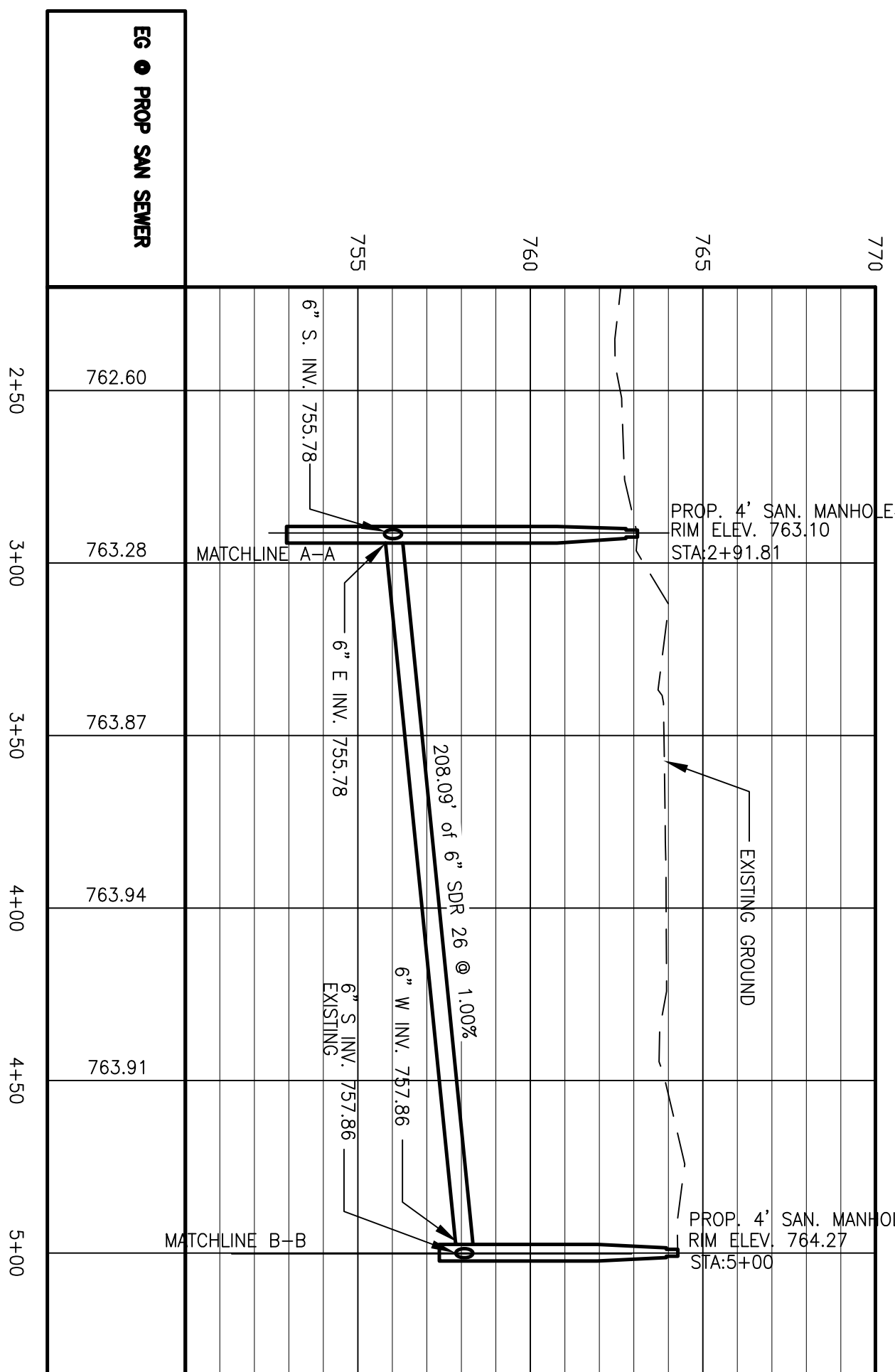
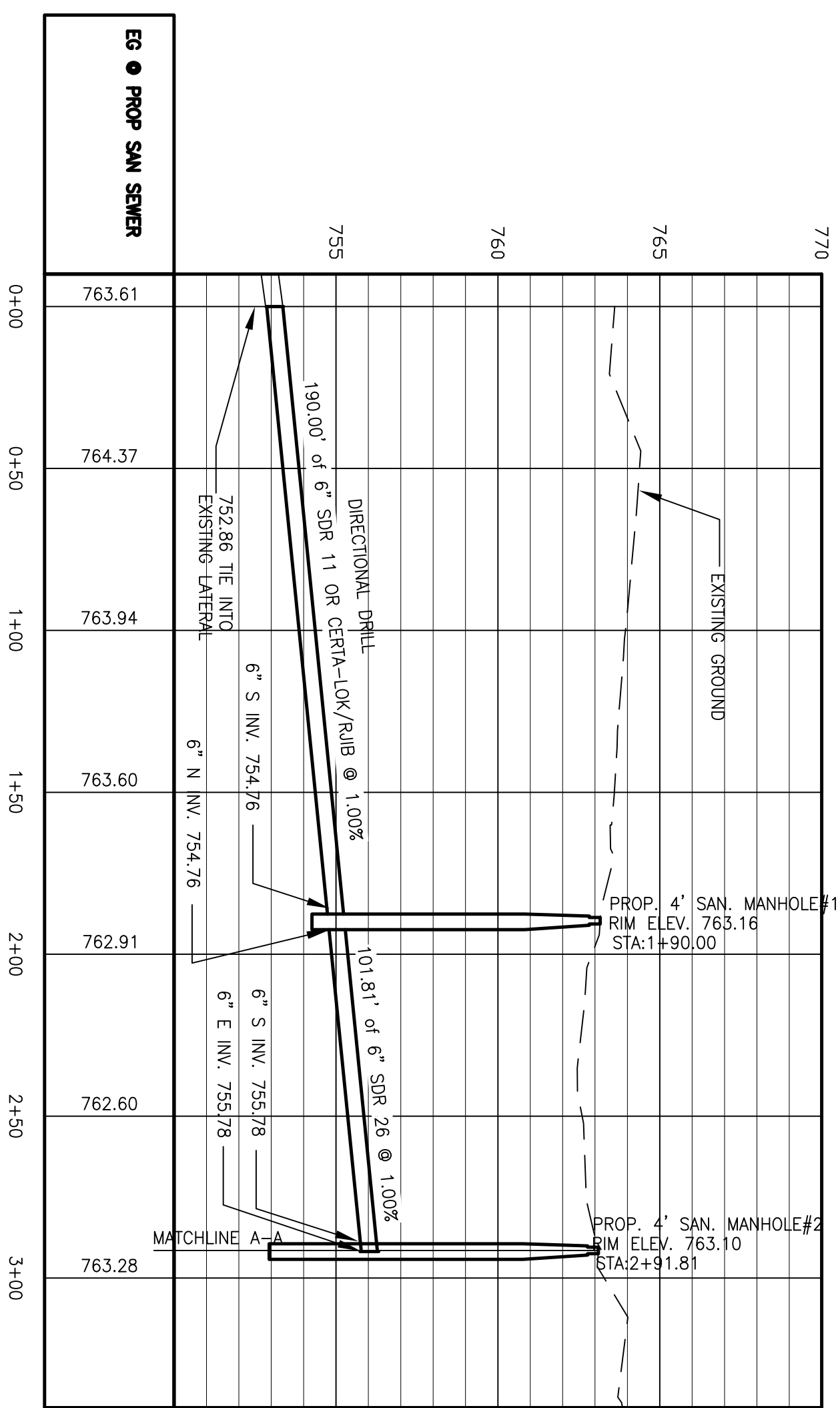
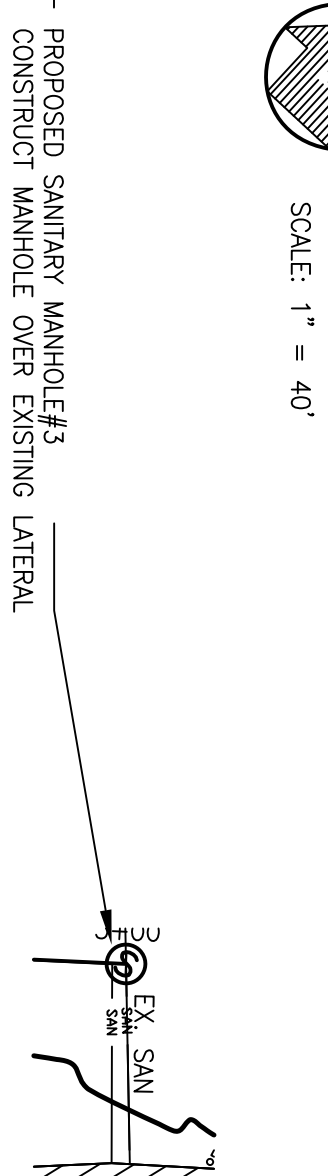

MANHOLE STRUCTURE SCHEDULE

MH#1 SANITARY SEWER MANHOLE
6" PVC SOUTH INVERT ELEV. = 754.85'
12" SOUTH INVERT ELEV. = 743.16'
12" WEST INVERT ELEV. = 743.04'
12" EAST INVERT ELEV. = 743.16'
MH#2 SANITARY SEWER MANHOLE
RIM = 763.26'
6" PVC EAST INVERT ELEV. = 755.80'
6" PVC NORTH INVERT ELEV. = 755.65'
MH#3 SANITARY SEWER MANHOLE
RIM = 764.54'
12" EAST INVERT ELEV. = 744.34'
12" WEST INVERT ELEV. = 744.13'
PROPOSED SANITARY MANHOLE#1
RIM ELEV. = 763.69
6" NORTHWEST INVERT ELEV. = 755.98
6" SOUTHWEST INVERT ELEV. = 755.98
PROPOSED SANITARY MANHOLE#2
RIM ELEV. = 764.27
6" NORTHWEST INVERT ELEV. = 757.86
6" SOUTHWEST INVERT ELEV. = 757.86

- △ - TRAVERSE POINT
- - WELL
- - HIGHWAY
- - MONUMENT
- - FOUND IRON STAKE
- - SET IRON STAKE
- - SIGN
- - RR SIGN
- - GUY POLE
- - UTILITY POLE
- - LIGHT POLE
- - POST
- - SOL BORING
- - MAILBOX

- - SHRUB
- - DECIDUOUS TREE
- - CONIFEROUS TREE
- - EXISTING FIRE HYDRANT
- - EXISTING WATER VALVE
- - EXISTING GAS METER
- - EXISTING WATER METER
- - EXISTING TELEPHONE RISER
- - EXISTING ELECTRIC RISER
- - EXISTING CATCH BASIN
- - EXISTING ROUND CATCH BASIN
- - EXISTING UTILITY MANHOLE
- - EXISTING SANITARY MANHOLE
- - EXISTING ELECTRIC MANHOLE
- - EXISTING TELEPHONE MANHOLE
- - EXISTING TELEPHONE MANHOLE

LEGEND

—	OE	—	EXISTING OVERHEAD UTILITY LINE
—	E	—	EXISTING WATER UTILITY LINE
—	STM	—	EXISTING GAS UTILITY LINE
—	SAV	—	EXISTING STORM UTILITY LINE
—	—	—	EXISTING SANITARY UTILITY LINE
—	—	—	EXISTING TELEPHONE UTILITY LINE
—	—	—	EXISTING ELECTRIC RISER
—	—	—	EXISTING WATER METER
—	—	—	EXISTING GAS METER
—	—	—	EXISTING CATCH BASIN
—	—	—	EXISTING ROUND CATCH BASIN
—	—	—	EXISTING UTILITY MANHOLE
—	—	—	EXISTING SANITARY MANHOLE
—	—	—	EXISTING ELECTRIC MANHOLE
—	—	—	EXISTING TELEPHONE MANHOLE
—	—	—	PROPOSED SANITARY SEWER
—	—	—	PROPOSED SANITARY MANHOLE
—	—	—	PROPOSED CLEANOUT

ALL UTILITIES AS SHOWN ARE APPROXIMATE LOCATIONS DERIVED FROM ACTUAL MEASUREMENTS AND AVAILABLE RECORDS. THEY SHOULD NOT BE INTERPRETED TO BE EXACT LOCATION NOR SHOULD IT BE ASSUMED THAT THEY ARE THE ONLY UTILITIES IN THE AREA.

Sidock Group, Inc.
ENGINEERS • ARCHITECTS • CONSULTANTS • PROJECT MANAGERS

43155 MAIN STREET, SUITE 2310 • NOVI, MICHIGAN 48375 • (248) 349-4500
379 W. WESTERN AVE., SUITE 200 • MUSKEGON, MICHIGAN 49440 • (231) 722-4900

ST. BARTHOLOMEW CHURCH
CITY OF NEWAYGO, MICHIGAN

SANITARY LATERAL PROFILES
1000 W. BROOKS STREET

Drawn: ELS
Checked: WPF
Scale: 1" = 40'
Date: 9-26-22
Rev. By: _____
Rev. Date: _____

Job No.	222544A	Rev.	B	Description	ADDENDUM 1	Date	3/10/23	By	KHG
File Name	222544AC2	Rev.	A	Description	ISSUR FOR BID	Date	2/21/23	By	WPP
Job	222544A	Rev.		Description		Date		By	